



Flat 1, 28 Grove Vale

London, SE22 8EF

£1,500 Per Month

Galloways are pleased to present to the market this stunning one-bedroom flat on Grove Vale. The property has been newly refurbished to a high standard throughout and benefits from having a modern fitted kitchen, contemporary bathroom suite, and lots of natural light. The property is situated in the heart of East Dulwich providing easy access to a fantastic array of local amenities, shops, restaurants, and bars. While also being within close proximity to East Dulwich, and Denmark Hill train stations. This property is available to let immediately.

Southwark Council
Council Tax Band B £1240 per annum

Viewing

Please contact our Galloways West Norwood Office on 020 8766 6111

if you wish to arrange a viewing appointment for this property or require further information

- ONE BEDROOM
 - NEWLY REFURBISHED
 - EXCELLENT CONDITION
 - WHITE GOODS INCLUDED
 - AVAILABLE TO LET
 - GAS CENTRAL HEATING
 - DOUBLE GLAZING
 - 1 MINUTE WALK TO EAST DULWICH STATION
 - 15 MINUTE WALK TO DENMARK HILL STATION
- (TIMES ESTIMATED VIA GOOGLE MAPS)



1



1



1



C

Floor Plan

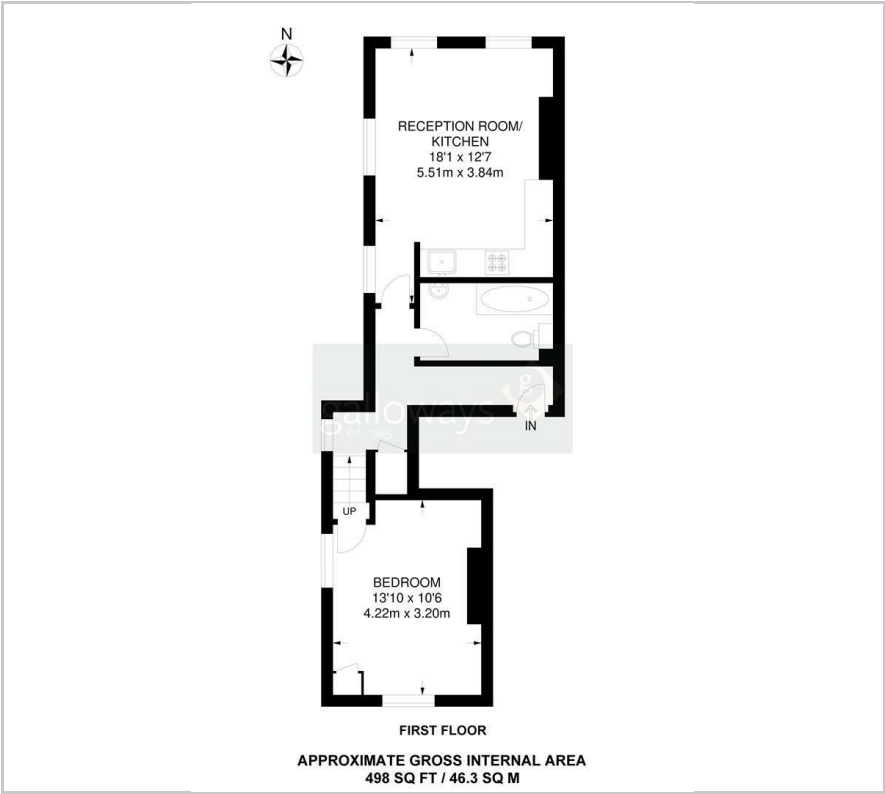

Area Map



Energy Efficiency Graph

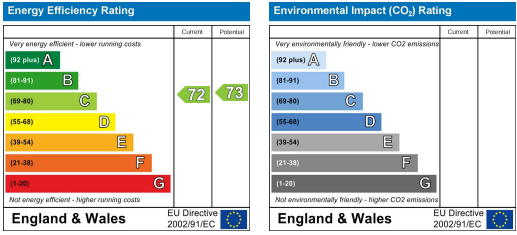

These particulars, whilst believed to be accurate are set out as a general outline only for guidance and do not constitute any part of an offer or contract. Intending purchasers should not rely on them as statements of representation of fact, but must satisfy themselves by inspection or otherwise as to their accuracy. No person in this firms employment has the authority to make or give any representation or warranty in respect of the property.